Owner's Manual



Universal Remote TRAINING SYSTEM

PET STOP®
Safer by design. Greater peace of mind.™

The Best Fence You'll Never See.®

WARNING: No user-serviceable parts inside. Contact manufacturer or authorized personnel for service.

WARNING: Risk of fire or electric shock. Connect only to UL listed Class 2 transformer for supply connection.

CAUTION: Risk of electric shock. Install transmitter indoors. Do not expose to rain.

COMPLIANCE STATEMENT (PART 15.19)

This device complies with Part 15 of the FCC Rules.

Operation is subject to the following two conditions:

1. This device may not cause harmful interference, and
2. This device must accept any interference received, including interference that may cause undesired operation.

WARNING (PART 15.21)

Changes or modifications not expressly approved by Perimeter Technologies, Inc., could void the user's authority to operate the equipment.

FCC INTERFERENCE STATEMENT (PART 15.105(b))

This equipment has been tested and found to comply with the limits of Class B digital device, pursuant to Part 15 of the FCC rules. These limits are designed to provide reasonable protection against harmful interference in a residential installation. This equipment generates, uses and can radiate radio frequency energy and, if not installed and used in accordance with the instructions, may cause harmful interference to radio communications. However, there is no guarantee that interference will not occur in a particular installation. If this equipment does cause harmful interference to radio or television reception, which can be determined by turning the equipment off and on, the user is encouraged to try to correct the interference by one or more of the following measures:

- reorient or relocate the receiving antenna
- increase the separation between the equipment and the receiver
- connect the equipment to an outlet or a circuit different from that to which the receiver is connected
- consult the dealer or an experienced radio/TV technician for help.

IMPORTANT



SYSTEM PRECAUTIONS

Any tight collar or consistent pressure on the skin can cause a condition known as pressure necrosis (bed sores) which if left untreated can be severe. To help reduce the likelihood of pressure necrosis, please do the following: Remove the pet's training collar every 12 hours. Look for any skin irritation and discontinue product use until healed. Wash pet's neck and collar frequently with warm soap and water. Do not attempt to wash the collar receiver in the washing machine or dish washer.

No training or containment method is full proof and your Universal Remote Training system is not a substitute for responsible pet ownership and close supervision of your pet.

Never use this product if you believe your pet is a danger to people, other animals or itself. Discontinue use immediately should your pet demonstrate any aggressive reaction to this product and seek professional training guidance.

Keep your dog safely contained and on a leash during the initial training.

Introduction

Congratulations!

You've selected the Universal Remote Training system by Pet Stop®. The Universal Remote is the fast and easy way to enjoy the freedom and peace of mind that your pet fencing system provides, even when you are away from home. It's great for solving frustrating problem behaviors such as digging, jumping and not coming when called.

How It Works:

The Universal Trainer transmits a brief attention getting pulse, pleasant vibration or audible warning tone to your dog's fencing collar reminding him that the healthy respect for his fence at home applies when you two are in the house or away from home too! For fence trained dogs the tone only option can instantly bring his attention back you just when you need it most.

The Universal Remote Training System Includes:

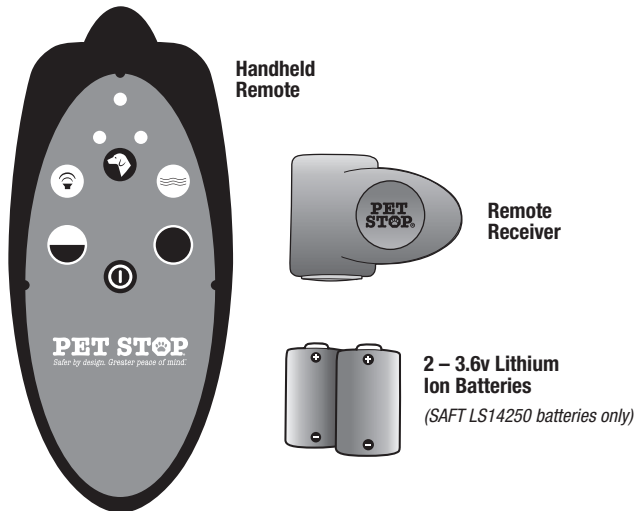

For the best results, please read this manual and all accompanying information in its entirety. If you have any questions, please contact your local Pet Stop dealer.

PET STOP®

Safer by design. Greater peace of mind.™

Remote Functions

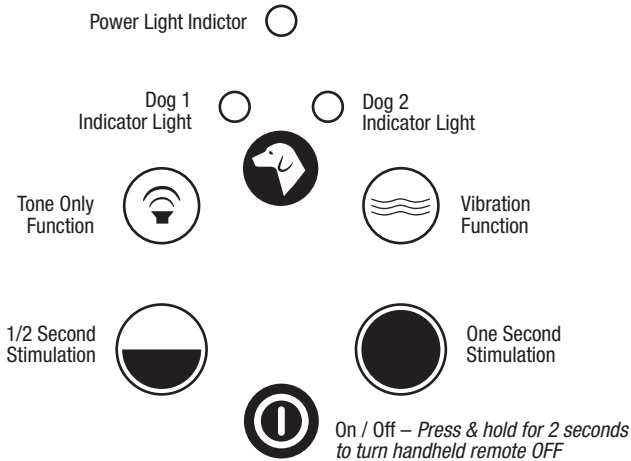

TONE ONLY

Press and hold the TONE button to activate the warning tone for up to 10 seconds. After ten seconds the button needs to be released and pressed again to reactivate. Most dog fence trained pets will respond quickly to only the warning tone without need for additional stimulation.

VIBRATION

The VIBRATION function is most often used as a “praise button” or positive reinforcement for positive behaviors. Providing treats or praise while pressing the vibration button will help reward your dog for desirable behaviors.

½ SECOND STIMULATION

Press and release to provide a brief ½ second of stimulation from the fencing collar receiver.

1 SECOND STIMULATION

Press and release to provide a longer 1 full second of stimulation from the fencing collar receiver for difficult or dangerous situations.



NOTE: The Handheld Remote will emit a long beep and flashing red light should any command from the Handheld and the remote receiver fail. This condition is most likely caused by the pet being out of range. Move closer and attempt again. With a direct line of sight, you can expect the effective range to be 150 feet.

Before First Use

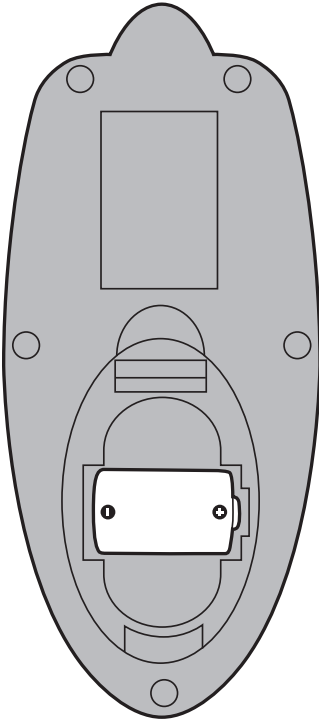

STEP ONE

Insert one 3.6v lithium ion battery in the back of the handheld remote with the (+) terminal facing to the right of the battery compartment.

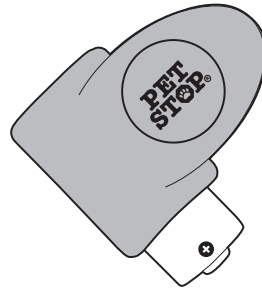

Insert the second 3.6v lithium ion battery in the remote receiver with the (+) terminal facing towards the battery compartment opening. Using a small coin, replace the battery cap turning clockwise.

STEP TWO

- Press and hold the ON/OFF button for one second; there is a small delay to power up the handheld remote. The indicator lights will briefly blink.
- Select DOG 1 (left) or DOG 2 (right) by pressing and releasing the DOG TOGGLE button.
- Press and hold the DOG TOGGLE button. The DOG LIGHT will slowly flash red.

Successful set up will be confirmed with a flashing green light.

- This setup function only needs to be performed once. The Universal Remote will retain the collar's unique code.
- Press and hold the TONE or VIBRATE functions to ensure proper operation of the Remote Receiver unit.

Before First Use

STEP THREE

Attach the Remote receiver to the fencing collar nylon strap. The location can be to the right or left, but within 3 inches of fencing collar receiver for proper stimulation activation.



STEP FOUR

The Universal Remote needs to be programmed to provide stimulation from the systems pet fence collar. To program the Universal Remote to any brand of pet fence use the following steps:

1. Walk the Handheld Remote unit out into the yard and stand over or near the system's fencing buried wire. Near the end of the driveway is a likely spot.
2. Press and hold the DOG TOGGLE BUTTON and the TONE BUTTON simultaneously
3. Flashing RED lights for two seconds indicates no containment field was found – try another fence boundary location.
4. The Handheld remote will indicate successful programming with steady RED lights for two seconds – the system is now fully operational.

Manual Programing

In the event that the Universal Remote cannot automatically detect your particular system frequency settings, you can manually program the remote following the steps below:

1. Simultaneously press and hold the DOG TOGGLE button and the TONE button for three seconds or until the POWER light is solid red.
2. Release the DOG TOGGLE and POWER buttons.
3. Press the TONE button the number of times that corresponds to your particular fence manufacturer and frequency setting. The POWER light will blink off for a short time to confirm your selection.
4. Press and release the VIBRATION button. The POWER light will blink to confirm the number you have selected.

	BRAND	FREQUENCY
1	Pet Stop	7K
2	Pet Stop	10K
3	Pet Stop	14K
4	Pet Stop	4K
5	Dog Guard	7K
6	Dog Guard	10K
7	Dog Guard	15K
8	Invisible Fence	7K
9	Invisible Fence	10K
10	Invisible Fence	15K
11	Dog Watch	7K AM
12	Dog Watch	4K AM
13	PetSafe	7K
14	PetSafe	10K
15	PetSafe	15K

Indicator Light Chart

	POWER LIGHT INDICATOR	DOG LIGHT INDICATORS
OFF	Unit turned off or functioning normally.	Unit turned off or DOG not selected.
SOLID RED	System successfully programmed.	N/A
SOLID GREEN	N/A	Operation normal.
FLASHING RED	Battery in handheld remote is low.	Contact is lost or remote receiver is out of range.
FLASHING GREEN	N/A	Operation normal. Battery in collar unit is low.

Notes

Notes

THIS
PAGE LEFT
INTENTIONALLY
BLANK

LIMITED LIFETIME WARRANTY

Perimeter Technologies® , Inc. warrants that its products to the original retail purchaser will be free from defects in material and workmanship, under normal use, for a period of one year from the date of the original retail purchase at no cost. Shipping to repair center not included. This coverage does not include accidental damage or misuse. After one year from date of original consumer purchase, Perimeter will, at our option repair, replace or upgrade the defective component at a fixed rate based on the component, for the life of the original owner. Owner must provide proof of purchase. Cost of shipping is not covered under the limited lifetime warranty. Some shipping charges may apply.

Your Local Authorized Pet Stop Dealer is:

Phone Number:

PET STOP
Safer by design. Greater peace of mind.™

Perimeter Technologies, Inc. • Morgantown, PA 19543

© 2009 Perimeter Technologies, Inc. All Rights Reserved. Printed in U.S.A.

Our products are covered by U.S. Patent Numbers: 5,460,124 – 5,682,839 – 6,296,776
Pet Stop, Comfort Contacts, Flash Alert, Safety Stop, Pet Fence Systems, The Best Fence You'll
Never See, TriScann, Zapp Alert, UltraElite Receiver, UltraMax Receiver, The Dog Fence People,
PowerWizard and RoomWizard are registered trademarks of Perimeter Technologies, Inc.

www.petstop.com